

**TRUST YOUR
ADVENTURE WITH
CARAVAN WORLD**



645 Chevallum Rd, Chevallum QLD
4555

(07) 5445 2215

sales@caravanworld.biz

www.caravanworld.biz



FULL BROCHURE RANGE

See the entire range of caravans, motorhomes, campervans and RVs we have available at Caravan World. You'll be sure to find exactly what it is you are looking for, and if you need assistance go on to:
www.caravanworld.biz/contact-us
And we'll give you all the support you need



**Caravan
WORLD**
SUNSHINE COAST

TRACKVAN

BY MILLENNIUM
C A R A V A N S



Caravan
WORLD

 **2 Year Structural
Factory Warranty**

TRACKVAN

BY **MILLENNIUM**
C A R A V A N S

WELDED ALUMINIUM SANDWICH CONSTRUCTION

**TIMBER FREE
STRUCTURE**



WHY MILLENNIUM?

 **2 Year Structural
Factory Warranty**

 **MADE IN AUSTRALIA**

 **ALI FRAME
TIMBER FREE**

 **ALI EXTERIOR**
+ Interior walls & ceiling

 **FULL COMPOSITE FLOOR**
Which is lighter and stronger

At **Millennium Caravans**, we provide quality built caravans at extremely competitive prices using only the best appliances & materials throughout the construction. Our caravans are designed & constructed to the highest standards whilst always meeting Australian Design Rules and Federal Compliance Regulations. Building vans since 2008 with over 20 years in the industry

our dedication to detail has earned us a reputation for excellent customer service to our large existing client base, with many delighted existing owners in all states of Australia. We look forward to working with each of our buyers to create a product that exceeds their expectations.



Contact us Today on (07) 5445 2215

Email info@caravanworld.biz
Visit caravanworld.biz

SUNSHINE COAST

The **ALUMINIUM SERIES BY MILLENNIUM** offers luxury on two or four wheels. The highest quality materials and workmanship ensures this van is built to last and without compromise.

ALUMINIUM SERIES

EXTERNAL PROTECTION

- 1 PIECE FLOORING
- 4 MM ALUMINIUM COMPOSITE CLADDING
- 1 PIECE FIBER GLASS ROOF
- CHECKER PLATE FRONT
- 600 MM CHECKER PLATE SIDE SKIRTS
- CHECKER PLATE REAR
- HIGH DENSITY INSULATION

ELECTRICAL

- PROJECTA MANAGEMENT SYSTEM
- 1 X 160 WATT SOLAR PANEL
- 1 X 100 AMP BATTERY ON CHASSIS
- REMOTE / WIRELESS LIGHTING SYSTEM
- ANNEXE LIGHT X 1 (YELLOW BUG FEATURE)
- LED EXTERNAL GRAB HANDLE
- 12 PIN TRAILER PLUG & 50A ANDERSONS PLUG
- WINGARD SENSOR ANTENNA
- SPEAKERS - 2 INSIDE + 2 OUTSIDE
- USB OUTLET IN ALL READING LIGHTS
- MULTIPLE 240V POWER POINTS
- REVERSE CAMERA PACKAGE
- 2 X TELEVISION LOCATIONS

CHASSIS

- 3500 KG STANDARD ALKO COUPLING
- 6" JOCKEY WHEEL
- MESH TRAY IN THE A-FRAME
- 6" A-FRAME RIGHT TO SUSPENSION
- LOAD SHARING AXLE SUSPENSION
- 4" CHASSIS LIFT/RAISER
- DROP DOWN STABILISER LEGS
- WHEELS - 15" ALLOYS
- TYRES - 235 / R75 R16
- 3 ARMED BUMPER BAR
- SPARE WHEEL

INTERNAL

- QUEEN BED WITH STORAGE BELOW
- INNERSPRING PILLOWTOP MATTRESS
- FULL HEIGHT SPLASH BACK
- FULL HEIGHT STEEL DRAW RUNNERS
- WATERFALL DOORS WITH HIDDEN CATCHES
- PIANO HINGES THROUGH OUT
- WIRE PANTRY WHERE POSSIBLE
- UPHOLSTERY IN MATERIAL OR VINYL
- LIFT UP FOOT REST (ON MOST MODELS)

PLUMBING

- CERAMIC TOILET BOWL
- HIGH GRADE SINK / VANITY
- FULL OVEN + GRILL + COOKTOP (1 X ELECTRIC)
- 28 LITRE GAS + 240V HOT WATER SYSTEM
- DOMETIC 224L 3WAY FRIDGE
- GAS BAYONET UNDER TUNNEL BOOT
- TAP ON A-FRAME WITH COVER
- 2 X 95 LITRE WATER TANKS WITH GAUGES
- FLICK MIXER TAPS
- WASHING MACHINE STD IN MOST LAYOUTS
- GAS BOTTLES - 2 X 9KG

EXTERNAL

- LARGEST WINDOWS POSSIBLE
- ROLL OUT AWNING
- PICNIC TABLE - ANNEXE SIDE
- SHOWER /TOILET EXTRACTION HATCHES
- ROOF HATCHES WITH LED LIGHTS
- TV BRACKET AT PICNIC TABLE
- 1 PIECE EXTERNAL HATCHES
- SECURITY MESH ENTRY DOOR - MULTI LOCK
- TUNNEL BOOT - CHECKER PLATE BASE
- GENERATOR LOCKER (MOST LAYOUTS)

MAJOR APPLIANCES

- PROJECTA MANAGEMENT SYSTEM
- OVEN + GRILL + COOKTOP (1 X ELECTRIC)
- 28 LITRE GAS + 240V HOT WATER SYSTEM
- DOMETIC 224L 3WAY FRIDGE
- 12 VOLT EXTRACTION RANGHOOD
- TELEVISION - 24" LED/LCD 12 VOLT
- REMOTE/WIRELESS CONTROLLED LIGHTING
- STEREO 12V CD/MP3/RADIO
- DOMETIC IBIS 4 AIR CONDITIONER
- 240 VOLT MICROWAVE
- SENSOR WINGARD ANTENNA (WIND UP)



WHY NOT CHOOSE TRACKVAN AS YOUR NEXT PURCHASE?

- ✓ Australian built product from the ground up (We support Australia & Australian jobs where possible)
- ✓ Fiberglass internal wall + ceiling linings (Eliminates any change of internal water marks)
- ✓ Welded Aluminium body framework (Eliminates any chance of timber rot while adding strength to the build)
- ✓ 1 piece honey combe plastic floor – No timber (This eliminates the very common wet / spongy timber floor rot)
- ✓ One piece fiberglass roof (Less joins/seams helps reduce the chance of water ingress)
- ✓ 4 mm Aluminium Composite external cladding (Helps protect the van from the elements such as Rain & hail)



The TRACKVAN EXTREME BY MILLENNIUM steps you up to be able to see more destinations off the beaten track in luxury whilst touring our great country.

OFF-ROAD ALUMINIUM SERIES



EXTREME FEATURES

- ✓ D035 OFF ROAD COUPLING
- ✓ FRONT STONE DEFLECTOR WITH MUD FLAPS
- ✓ FRONT TOOL BOX WITH 2 X J/CAN HOLDERS
- ✓ DOUBLE PULL-OUT ENTRY STEP
- ✓ 3500 KG COIL INDEPENDENT SUSPENSION
- ✓ TWIN SHOCK ABSORBERS PER TRAILING ARM
- ✓ 12" DRUM BRAKE UPGRADE
- ✓ 3500 KG STAMPED ATM FOR MAXIMUM LOADING
- ✓ 2 X 160WATT SOLAR PANELS
- ✓ 2 X 100 LITHIUM BATTERIES (LIGHT WEIGHT)
- ✓ LITHIUM FRIENDLY BATTERY MANAGEMENT SYSTEM
- ✓ COMPRESSOR FRIDGE UPGRADE 224 LITRES
- ✓ FRONT & REAR WORK LIGHTS
- ✓ EXTERNAL HOT & COLD SHOWER SET
- ✓ BLACK INTERIOR FIXTURES PACK
- ✓ WATER FALL BENCH TOP
- ✓ BLACK INTERIOR FIT OUT PACK

Contact us today!

PH: (07) 5445 221
info@caravanworld.biz
www.caravanworld.biz



SUNSHINE COAST



18'6" Rear door – Single axle (Trackvan)

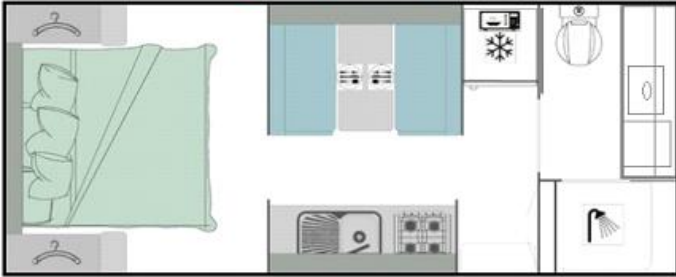

18'6" Rear door – Single axle (Trackvan)

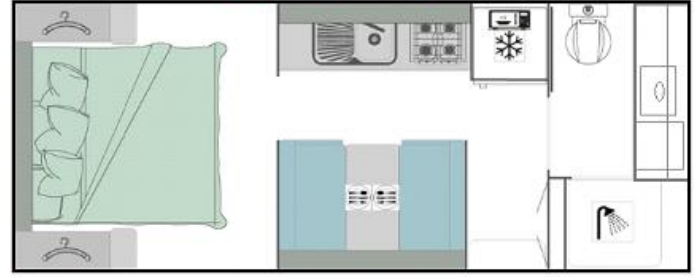

18'6" Mid Door – Single axle (Trackvan)

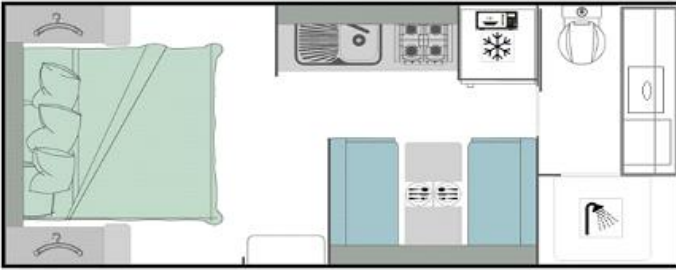

19' Mid Door – Tandem Axle (Trackvan)

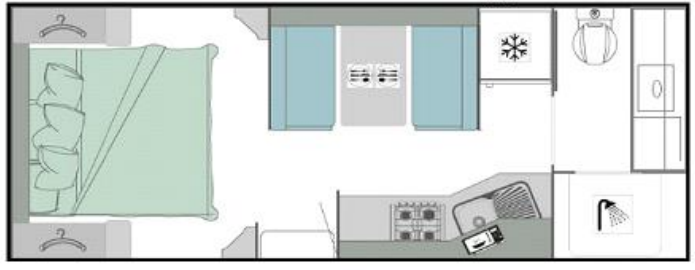

20'6" Rear door (Trackvan)

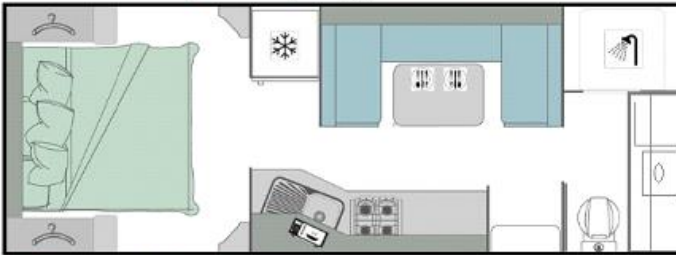

20'6" Rear door (Trackvan)

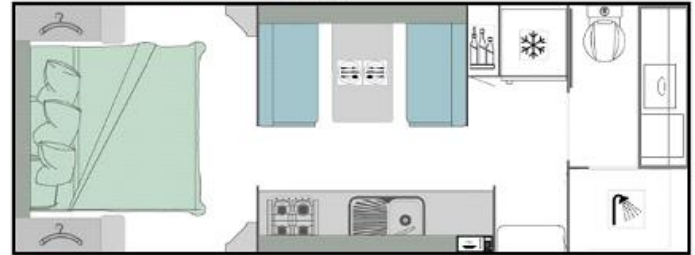

22'6" Rear club (Trackvan)

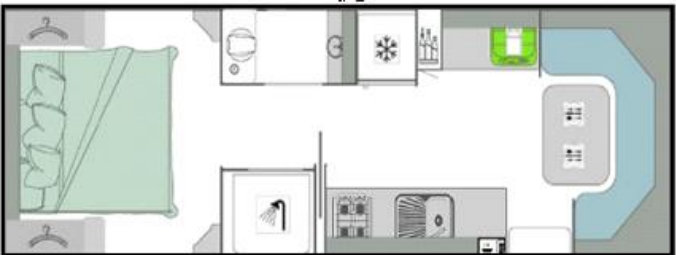

18'6" Family Layout (Trackvan)

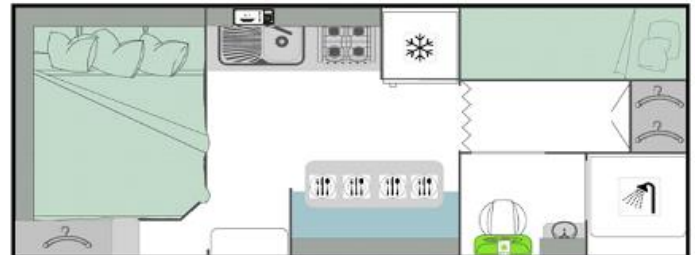

19'6" Family Layout (Trackvan)

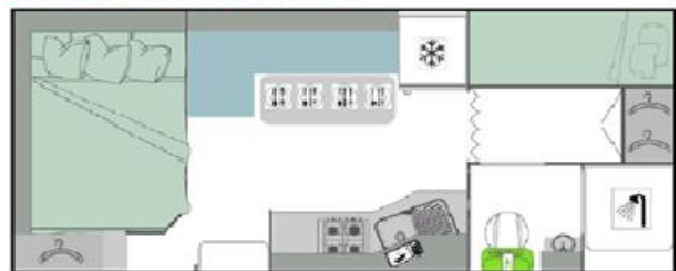

21'6" Family Layout (Trackvan) Club or "L" shape

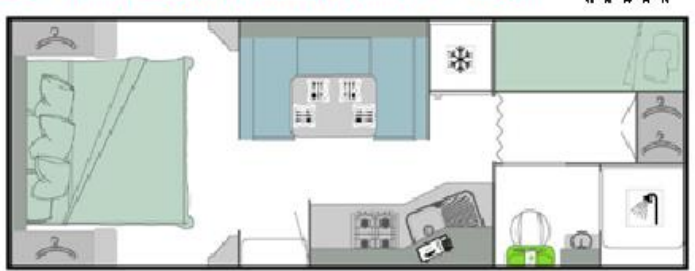

More layouts available

Disclaimer: While all care has been taken to ensure all specifications are correct at the time of printing, some details can change from time to time due to availability. Please confirm all details before purchasing with your sales representative. All photographs used are for display purposes only and may show some accessories that are not included with the van.

**2 Year Structural
Factory Warranty**

MADE IN AUSTRALIA



SUNSHINE COAST

**ALI FRAME
TIMBER FREE**

**ALI EXTERIOR
+ Interior walls & ceiling**

**FULL COMPOSITE FLOOR
Which is lighter and stronger**