

18' Family Layout (Single axle) ("L" Shape seating off side also available)

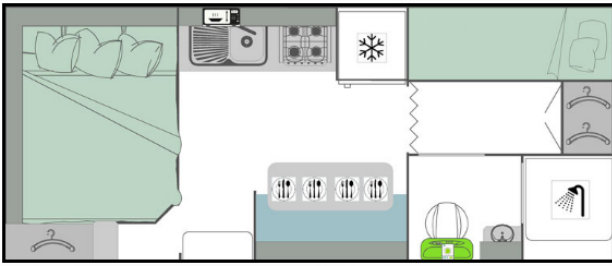

18'6" Rear Door (Single axle)

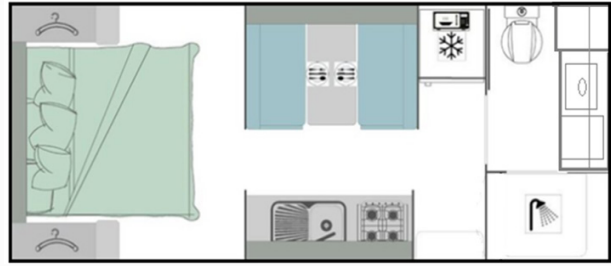

19'6" Family Layout



19' Mid Door – Tandem Axle

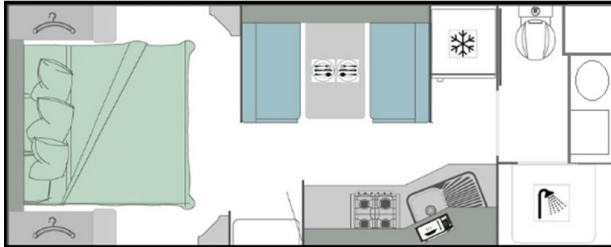

21'6" Family Layout

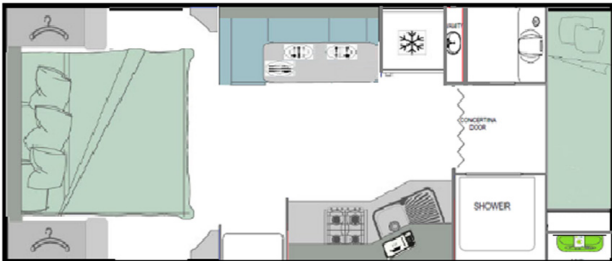

20'6" Rear door

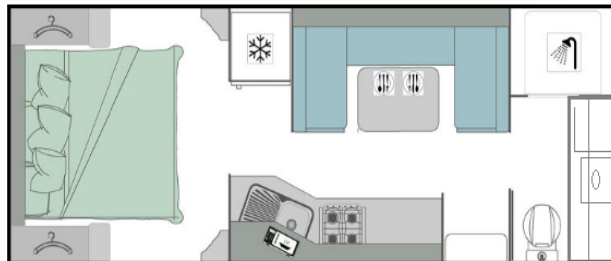

21'6" Family Layout (Club or "L" shape seating available)

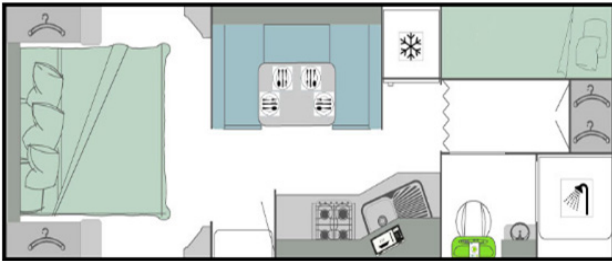

19'6" Rear door

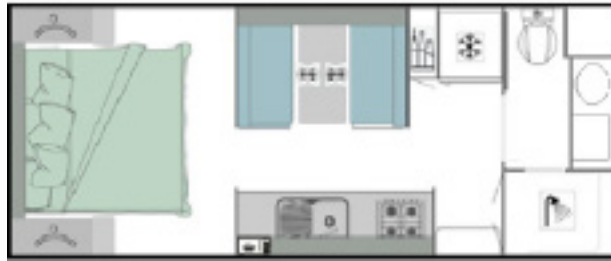

15'6" Mid door (Single axle)



20'6" Rear door

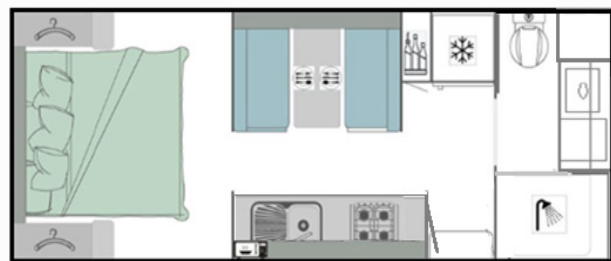

18' Mid door (Single axle)

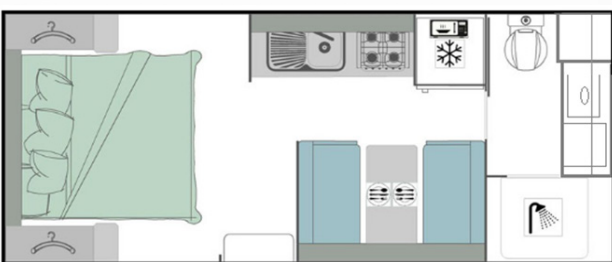

22'6" Rear club

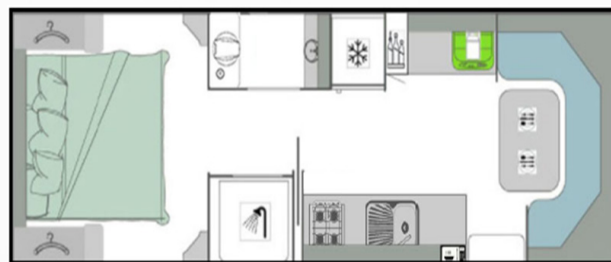



WHY CHOOSE TRACKVAN AS YOUR NEXT PURCHASE

- ✓ **Australian built product from the ground up** (We support Australia & Australian jobs where possible)
- ✓ **Fibreglass internal wall + ceiling linings** (Eliminates any chance of internal water damage)
- ✓ **Welded Aluminium body framework** (Eliminates any chance of timber rot while adding strength to the build)
- ✓ **1 piece honeycomb composite floor – No timber** (This eliminates the very common wet / spongy timber floor rot)
- ✓ **One piece fibreglass roof** (Less joins/seams helps reduce the chance of water ingress)
- ✓ **4mm Ali-Comp external cladding** (Helps protect the van from the elements such as Rain & hail)



CHASSIS SPECIFICATIONS

- 3500 kg standard alko coupling
- 6" jockey wheel
- Mesh tray in the a-frame
- 6" a-frame run through to suspension
- Single axle - coil independent suspension
- Tandem - 3200 kg axle suspension
- 4" chassis lift/raiser
- Drop down stabiliser legs
- Wheels - 16" alloys
- Tyres - 235 / r75 r16
- 3 armed bumper bar
- Spare wheel x 1

ELECTRICAL SPECIFICATIONS

- Projecta management system
- 1 x 180 watt solar panel
- 1 x 100 amp battery on chassis
- Remote / wireless lighting system
- Annexe light x 1 (yellow bug feature)
- Led external grab handle
- 12 pin trailer plug & 50a andersons plug
- Wingard sensor antenna
- Speakers - 2 inside + 2 outside
- Usb outlet in all reading lights
- Multiple 240v power points
- Reverse camera package
- Smart TV & Two mounting Locations

INTERNAL SPECIFICATIONS

- Queen bed with storage below
- Innerspring pillowtop mattress
- Full height splash back
- Soft close draw runners
- Waterfall doors with hidden catches
- Piano hinges through out
- Wire pantry where possible
- Upholstery in material or vinyl
- Foot stools on seat ends

PLUMBING SPECIFICATIONS

- Ceramic bowl toilet
- High grade sink / vanity
- Full oven + grill + cooktop (1 x electric)
- 28 litre gas + 240v hot water system
- Dometic 224l 3way fridge
- Gas bayonet under tunnel boot
- Tap on a-frame with cover
- 2 x 95 litre water tanks with gauges
- Flick mixer taps
- Washing machine standard in most layouts
- Gas bottles - 2 x 9kg

TRACKVAN
BY MILLENNIUM
CARAVANS



EXTERNAL SPECIFICATIONS

- Largest windows possible
- Roll out awning
- Picnic table - annexe side
- Shower /toilet extraction hatches
- Roof hatches with led lights
- Tv bracket at picnic table
- 1 piece external hatches
- Security mesh entry door - multi lock
- Tunnel boot - checker plate base
- Generator locker (most layouts)

MAJOUR APPLIANCES

- Projecta p300 12volt management system
- Oven + grill + cooktop (1 x electric)
- 28 litre gas + 240v hot water system
- Dometic 224l 3way fridge
- 12 volt extraction rangehood
- Television - 24" led/lcd 12 volt
- Wireless remote controlled lighting
- Stereo 12v cd/mp3/radio
- Air command ibis 4 air conditioner
- 240 volt microwave
- Sensor wingard antenna (wind up)

EXTERNAL PROTECTION

- 1 piece sheet floor
- 4 mm ali comp cladding
- 1 piece fibreglass roof
- Checker plate front
- 600 mm checker plate side skirts
- Checker plate rear
- High density insulation

OFF ROAD PACK

- D035 off road coupling
- Front stone deflector with mud flaps
- Front tool box + Sliders + 2 x j/can holders
- Double pull out entry step
- 3500 kg coil independent suspension
- Twin shock absorbers per trailing arm
- 12" drum brake upgrade
- 16" rims with 265 tyre upgrade
- Grey water holding tank
- 3500 kg stamped atm for maximum loading
- 2 x 180 watt solar panels
- 2 x 100 lithium batteries (light weight)
- Lithium friendly battery management system
- Compressor fridge upgrade 224 litres
- Front & rear work lights
- External hot & cold shower set
- Black interior fixtures pack
- Water fall bench top



ADDRESS
645 Chevallum Rd,
Chevallum QLD 4555
(Exit 200 next to the
BP north bound)



PHONE
(07) 5445 2215



WEBSITE
www.caravanworld.biz

